

MARIN LOCAL AGENCY FORMATION COMMISSION

RESOLUTION 25-10

RESOLUTION APPROVING A REORGANIZATION DETACHING 7 SUNRISE, LARKSPUR FROM ROSS VALLEY SANITARY DISTRICT AND ANNEXATION TO SANITARY DISTRICT NO. 2 OF MARIN COUNTY WITH WAIVER OF NOTICE, HEARING, AND PROTEST PROCEEDINGS

“Reorganization of 7 Sunrise, Larkspur (APN 021-154-08) detaching from Ross Valley Sanitary District and annexing into Sanitary District No. 2 (LAFCo File #1381)”

WHEREAS Sanitary District No. 2, filed an agency petition with the Marin Local Agency Formation Commission, hereinafter referred to as “Commission,” pursuant to the Cortese-Knox-Hertzberg Local Government Reorganization Act of 2000; and

WHEREAS the proposal seeks Commission approval to detach 7 Sunrise, Larkspur, which is approximately .26 acres of incorporated land from Ross Valley Sanitary District and annex into Sanitary District No. 2; and

WHEREAS the Commission’s staff has reviewed the proposal and prepared a report with recommendations; and

WHEREAS the staff’s report and recommendations on the proposal have been presented to the Commission in the manner provided by law; and

WHEREAS the Commission considered all the factors required by law under Government Code Section 56668 and 56668.3 and adopted local policies and procedures.

WHEREAS the proposal is for a reorganization of territory that is uninhabited, with 100% written consent received by landowners, and no affected local agency has submitted a written demand for notice and hearing as provided for in Government Code section 56662(a).

NOW THEREFORE, the Marin Local Agency Formation Commission **DOES HEREBY RESOLVE, DETERMINE AND ORDER** as follows:

Section 1. The boundaries, as set forth in the proposal for the reorganization, are hereby approved as submitted and are as described and depicted in Exhibits “A” and “B” attached hereto and by this reference incorporated herein.

Section 2. The territory includes .26 acres, is found to be uninhabited, and is assigned the following distinctive short form designation: “Reorganization of 7 Sunrise, Larkspur (APN 021-154-08) detaching from Ross Valley Sanitary District and annexing into Sanitary District No. 2 of Marin County (LAFCo File #1381)”

Section 3. The proposal is consistent with the adopted spheres of influence for Sanitary District No. 2.

Section 4. The Executive Officer is hereby authorized to waive notice and hearing, protest proceedings, and complete reorganization proceedings.

Section 5. As the Lead Agency under CEQA for the proposed annexation of APN 021-154-08 to Sanitary District No. 2, LAFCo finds that the Project is categorically exempt from the provisions of CEQA pursuant to State CEQA Guidelines Section 15319(a).

PASSED AND ADOPTED by the Marin Local Agency Formation Commission on February 13, 2025, by the following vote:

AYES: Commissioners Murray, Burdo, Chu, Lucan, Coler, Rodoni and Kious

NOES: _____

ABSTAIN: _____

ABSENT: _____

Barbara Coler
Barbara Coler (Feb 14, 2025 16:56 PST)
Barbara Coler, Chair

ATTEST:

Jason Fried
Jason Fried, Executive Officer

APPROVED AS TO FORM:

Malathy Subramanian
Malathy Subramanian (Feb 14, 2025 10:59 PST)
Malathy Subramanian, LAFCo Counsel

Attachments to Resolution No. 25-10

- a) Exhibit A – Legal Description
- b) Exhibit B – Map



Geographic Description

Annexation of APN 021-154-08
Into Sanitary District No 2
LAFCO File #: 1381
Page 1 of 3

All that certain real property, situate in the City of Larkspur, County of Marin, State of California, and a portion of Rancho Corte Madera Del Presidio, being the lands of Julia Earl as described in the Grant Deed recorded under Document Number 2006-0041790, Official Records of Marin County, described as follows:

Beginning at an angle point on the existing boundary of Sanitary District No 2, and also being the northernmost corner of Lot 108 as shown on that certain map titled Amended Map of Corte Madera Woods recorded March 16, 1912 in Book 4 of Maps at page 16, Marin County Records;

Course 1 – Thence along the existing boundary of Sanitary District No 2, South 44°19'00" West 101.73 feet to the southerly line of the Lands of Julia Earl as described in the Grant Deed recorded under Document Number 2006-0041790, Official Records of Marin County;

Course 2 – Thence leaving said existing district boundary, and along the southerly lines of said Lands of Earl, North 56°50'00" West 33.67 feet;

Course 3 – Thence along said southerly line, South 73°46'00" West 50.15 feet;

Course 4 – Thence along said line southerly line, South 85°14'50" West 62.56 feet to southerly right of way of Sunrise Lane;

Course 5 – Thence along said southerly line, North 14°52'00" West 20.00 feet to the centerline of Sunrise Lane;

Course 6 – Thence following the centerline of Sunrise Lane along a curve concave northerly, having a radial bearing of North 14°52'00" West, a radius of 60.00 feet and a central angle of 39°48'00" for an arc length of 41.68 feet;

Course 7 – Thence along said centerline, North 35°20'00" East 54.79 feet;

Course 8 – Thence leaving said centerline and along the northerly line of said lands of Earl, South 84°45'00" East 150.27 feet to the **Point of Beginning** and containing 0.26 acres of land more or less;

For assessment purposes only. This description of land is not a legal property description as defined in the Subdivision Map Act and may not be used as the basis for an offer for sale of the land described.

This description of land is intended for annexation of the lands described under Document Number 2006-0041790, into the Marin Sanitary District No. 2, only. Research of existing district boundaries was performed in preparation of this description; however, no maps or legal descriptions describing existing district boundaries were recovered. Therefore, this description relies upon existing parcel descriptions, a listing of assessor's parcels serviced by the district, and the MarinMap Map Viewer graphical information system as the best available evidence to determine existing district boundaries. No gaps between existing district boundaries and the easterly line of the lands described herein are intended.



Geographic Description

Annexation of APN 021-154-08
Into Sanitary District No 2
LAFCO File #: 1381
Page 2 of 3

Prepared by:
BKF ENGINEERS

A handwritten signature in cursive script that reads 'Daniel Langley'.

Daniel P. Langley, PLS. No. 9380

Dated: 08/20/2024



LOCATED IN RANCHO CORTE
MADERA DEL PRESIDIO



VICINITY MAP
NOT TO SCALE

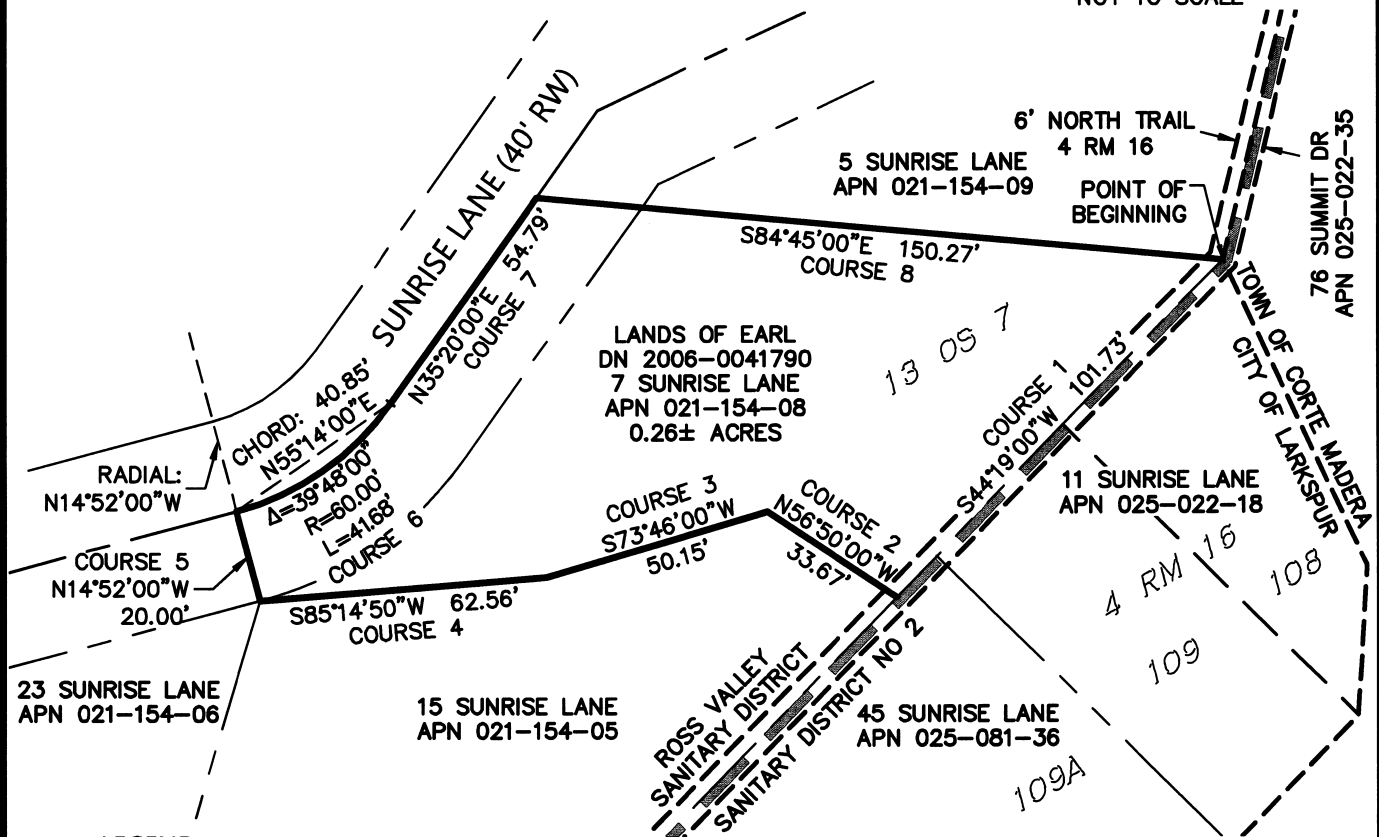
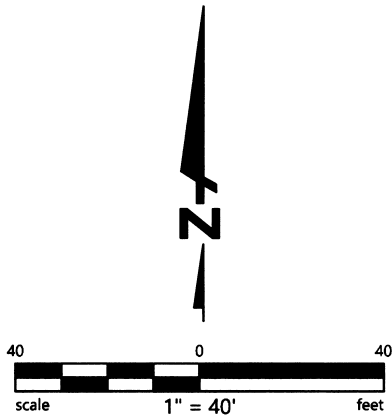

LEGEND

- EXISTING BOUNDARY OF SANITARY DISTRICT NO 2
- PROPOSED BOUNDARY OF SANITARY DISTRICT NO 2
- LIMITS OF CITY OF LARKSPUR & TOWN OF CORTE MADERA

DISCLAIMER:

FOR ASSESSMENT PURPOSES ONLY. THIS DESCRIPTION OF LAND IS NOT A LEGAL PROPERTY DESCRIPTION AS DEFINED IN THE SUBDIVISION MAP ACT AND MAY NOT BE USED AS THE BASIS FOR AN OFFER FOR SALE OF THE LAND DESCRIBED.

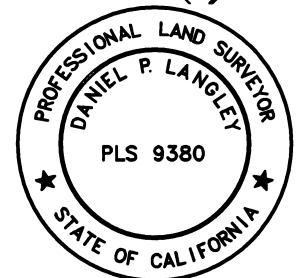

BKF ENGINEERS
 4040 CIVIC CENTER DR.
 SUITE 530
 SAN RAFAEL, CA 94903
 (415) 930-7960
 www.bkf.com

ANNEXATION OF
 APN 025-154-08 INTO
 SANITARY DISTRICT NO 2
 LAFCO FILE #: _____
 MARIN MAPPING #: _____

JOB # 20230192-01
 DATE AUG. 2024
 CHECKED. JPS
 SHEET 3 OF 3











Resolution 25-10 Fie 1381

Final Audit Report

2025-02-18

Created:	2025-02-14
By:	claire devereux (cdevereux@marinlafco.org)
Status:	Signed
Transaction ID:	CBJCHBCAABAAZkD-0xbB9y854rTCqJbPgx_EcQul7iwV

"Resolution 25-10 Fie 1381" History

-  Document created by claire devereux (cdevereux@marinlafco.org)
2025-02-14 - 6:40:35 PM GMT
-  Document emailed to Jason Fried (jfried@marinlafco.org) for signature
2025-02-14 - 6:40:41 PM GMT
-  Document emailed to malathy.subramanian@bbklaw.com for signature
2025-02-14 - 6:40:42 PM GMT
-  Document emailed to barbaracoler@gmail.com for signature
2025-02-14 - 6:40:42 PM GMT
-  Email viewed by malathy.subramanian@bbklaw.com
2025-02-14 - 6:59:18 PM GMT
-  Signer malathy.subramanian@bbklaw.com entered name at signing as Mala Subramanian
2025-02-14 - 6:59:40 PM GMT
-  Document e-signed by Mala Subramanian (malathy.subramanian@bbklaw.com)
Signature Date: 2025-02-14 - 6:59:42 PM GMT - Time Source: server
-  Email viewed by barbaracoler@gmail.com
2025-02-15 - 0:55:51 AM GMT
-  Signer barbaracoler@gmail.com entered name at signing as Barbara Coler
2025-02-15 - 0:56:18 AM GMT
-  Document e-signed by Barbara Coler (barbaracoler@gmail.com)
Signature Date: 2025-02-15 - 0:56:20 AM GMT - Time Source: server
-  Email viewed by Jason Fried (jfried@marinlafco.org)
2025-02-18 - 5:13:25 PM GMT

 Document e-signed by Jason Fried (jfried@marinlafco.org)

Signature Date: 2025-02-18 - 5:13:42 PM GMT - Time Source: server

 Agreement completed.

2025-02-18 - 5:13:42 PM GMT